

MCG Spiral Shaft Rings

External, Heavy Duty, Metric

The rigors of the toughest applications are easily handled by this external series. Its large size, and ease of application and removal, transfers into an assurance of quality for demanding uses.

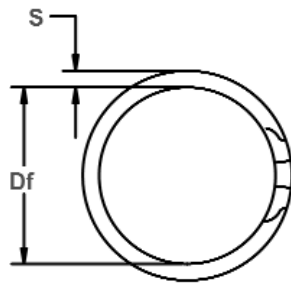

Free Diameter & Ring Measurements

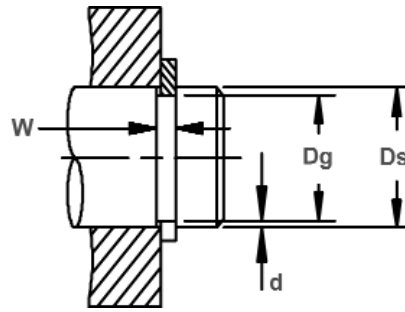
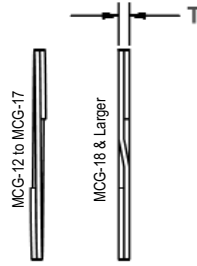

Shaft Diameter & Groove Dimensions

RING NO.	SHAFT DIAMETER	GROOVE SIZE				RING SIZE						THRUST LOAD (N)	
		DIAMETER		WIDTH		FREE DIAMETER		THICKNESS		SECTION		RING Safety factor of 3	GROOVE Safety factor of 2
		(mm)	Dg	Tol.	W	Tol.	Df	Tol.	T	Tol.	S		
MCG-12	12	11.29		0.70		11.18		0.60		1.14		7954	2461
MCG-13	13	12.24	+0.05	1.00		12.13		0.89		1.27		11528	1930
MCG-14	14	13.19	-0.05	1.00		13.06		0.89		1.27		12415	2384
MCG-15	15	14.09		1.00		13.98		0.89		1.27		13302	3181
MCG-16	16	15.03		1.00		14.90		0.89		1.40		14188	3811
MCG-17	17	16.03		1.00		15.82		0.89		1.40		15075	4107
MCG-18	18	16.93		1.00		16.80		1.07		1.65		19190	4561
MCG-19	19	17.88		1.20	+0.08	17.73		1.07		1.65		20256	5309
MCG-20	20	18.78	+0.08	1.20	-0.00	18.62		1.07		1.65		21323	6427
MCG-21	21	19.73	-0.08	1.20		19.57		1.07		1.65		22389	7470
MCG-22	22	20.63		1.20		20.45	+0.00	1.07	+0.05	1.91	+0.08	23455	8686
MCG-23	23	21.58		1.20		21.39	-0.33	1.07	-0.05	1.91	-0.13	24521	9906
MCG-24	24	22.53		1.20		22.35		1.07		1.91		25587	11366
MCG-25	25	23.43		1.20		23.25		1.07		2.16		26653	13132
MCG-26	26	24.43		1.20		24.21		1.07		2.16		27719	14085
MCG-27	27	25.35		1.40		25.04		1.27		2.62		31195	10968
MCG-28	28	26.30		1.40		26.00		1.27		2.62		32350	12439
MCG-29	29	27.27		1.40		26.95		1.27		2.62		33506	13626
MCG-30	30	28.25	+0.10	1.40	+0.10	27.92		1.27		2.62		34661	14898
MCG-31	31	29.17	-0.10	1.40	-0.00	28.84		1.27		2.62		35817	16835
MCG-32	32	30.10		1.40		29.77		1.27		2.62		36972	18840
MCG-34	34	31.90		1.40		31.54		1.27		3.00		39283	23123
MCG-35	35	32.80		1.40		32.44		1.27		3.00		40438	25932
MCG-36	36	33.75		1.40		33.40		1.27		3.00		41593	27964
MCG-37	37	34.67	+0.15	1.40		34.24		1.27		3.00		42749	29763
MCG-38	38	35.65	-0.15	1.40		35.18		1.27		3.00		43904	30830

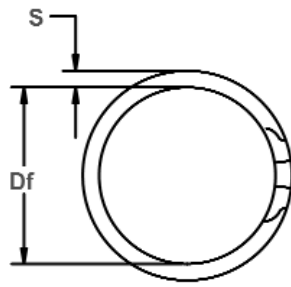

Free Diameter & Ring Measurements

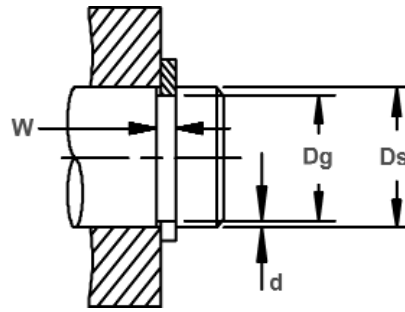
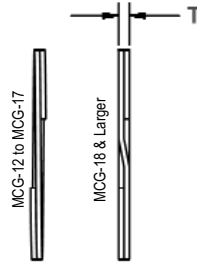

Shaft Diameter & Groove Dimensions

RING NO.	SHAFT DIAMETER	GROOVE SIZE				RING SIZE				THRUST LOAD (N)			
		DIAMETER		WIDTH		FREE DIAMETER		THICKNESS		S	Tol.	RING Safety factor of 3	GROOVE Safety factor of 2
		(mm)	Dg	Tol.	W	Tol.	Df	Tol.	T				
MCG-40	40	37.55	+0.15 -0.15	1.75	+0.10 -0.00	37.15	+0.00 -0.51	1.57	+0.08 -0.13	3.25	57132 30470		
MCG-42	42	39.45		1.75		39.02		1.57		3.25			
MCG-45	45	42.25		1.75		41.77		1.57		3.25			
MCG-46	46	43.15		1.75		42.67		1.57		3.25			
MCG-47	47	44.31		1.75		43.81		1.57		4.01			
MCG-48	48	45.05		1.75		44.48		1.57		4.01			
MCG-50	50	47.05		1.75		46.69		1.57		4.01			
MCG-52	52	48.95		2.15		48.60		1.98		4.27			
MCG-54	54	50.85		2.15		50.52		1.98		4.27			
MCG-55	55	51.65		2.15		51.26		1.98		4.27			
MCG-57	57	53.60	+0.20 -0.20	2.15	+0.13 -0.00	53.17	+0.00 -0.64	1.98	+0.10 -0.15	4.27	102673 66907		
MCG-58	58	54.50		2.15		54.08		1.98		4.27			
MCG-60	60	56.50		2.15		56.05		1.98		5.08			
MCG-62	62	58.40		2.15		57.99		1.98		5.08			
MCG-65	65	61.40		2.15		60.92		1.98		5.08			
MCG-68	68	64.30		2.15		63.80		1.98		5.08			
MCG-70	70	66.20		2.55		65.70		2.29		5.72			
MCG-72	72	68.10		2.55		67.57		2.29		5.72			
MCG-75	75	71.00		2.55		70.47		2.29		5.72			
MCG-78	78	73.80		2.55		73.25		2.29		5.72			
MCG-80	80	75.70	2.55	75.12	2.29	5.72							
MCG-82	82	77.60	2.55	77.00	2.29	5.72							
MCG-85	85	80.40	2.55	79.79	2.29	5.72							
MCG-88	88	83.30	2.95	82.67	2.72	6.86							
MCG-90	90	85.20	2.95	84.54	2.72	6.86							
MCG-95	95	90.00	2.95	89.32	2.72	6.86							
MCG-100	100	94.80	2.95	94.09	2.72	6.86							